

## Marketing Preview



**27 Cecil Square, Sheffield, S2 4NT**

**£200,000**

**Bedrooms 3, Bathrooms 1, Reception Rooms 1**



NO CHAIN This three bedroom end of terrace property would be a fantastic investor opportunity and ideal as a rental property. The property offers masses of potential, with cellar space and an attic bedroom. There is a low-maintenance yard to the rear. Located just off Sheffield's vibrant London Road, it is perfect for city living, within walking distance of West Street and Ecclesall Road, and on the doorstep of a wide range of amenities.

## SUMMARY

NO CHAIN This three bedroom end of terrace property would be a fantastic investor opportunity and ideal as a rental property. The property offers masses of potential, with cellar space and an attic bedroom. There is a low-maintenance yard to the rear. Located just off Sheffield's vibrant London Road, it is perfect for city living, within walking distance of West Street and Ecclesall Road, and on the doorstep of a wide range of amenities.

Entrance to the lounge with the stair rise to the first floor and access to the cellar which mirrors the lounge via a trap door. Open to the kitchen/diner with access to the rear yard.

The first floor comprises of a large bedroom to the front with a large storage cupboard, a further single bedroom to the rear and a spacious shower room.

The second floor has a larger than average double bedroom with a walk in wardrobe with storage and a window overlooking the rear.

The rear garden is patio'd and is shared access for neighbours.

## PROPERTY DETAILS

- LEASEHOLD, 760 YEARS REMAINING, £17.50PA GROUND RENT
- FULLY UPVC DOUBLE GLAZED
- GAS CENTRAL HEATING
- COMBI BOILER
- COUNCIL TAX BAND A - SHEFFIELD CITY COUNCIL

FOR ROOM MEASUREMENTS PLEASE SEE THE FLOORPLAN

## Ground Floor

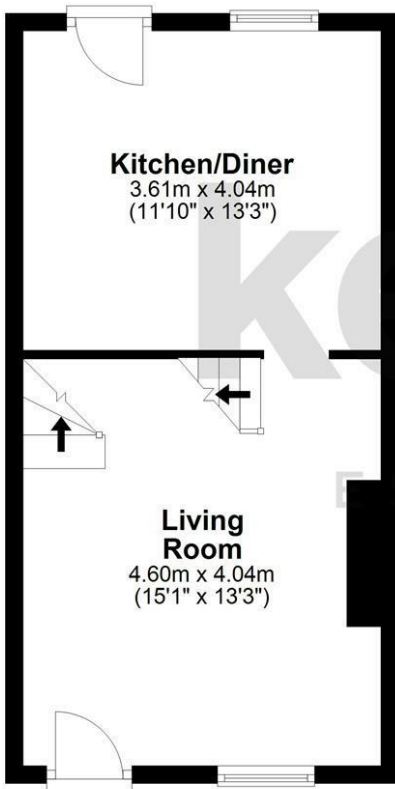

## First Floor

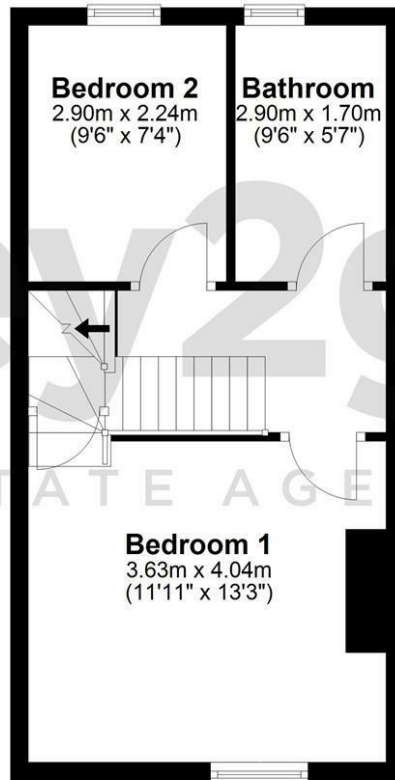

## Second Floor

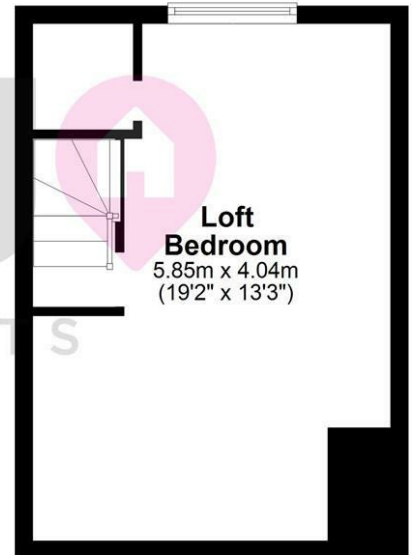

### Energy Efficiency Rating

	Current	Potential
Very energy efficient - lower running costs		
(92 plus) <b>A</b>		
(81-91) <b>B</b>		
(69-80) <b>C</b>		<b>76</b>
(55-68) <b>D</b>	<b>60</b>	
(39-54) <b>E</b>		
(21-38) <b>F</b>		
(1-20) <b>G</b>		
Not energy efficient - higher running costs		
<b>England &amp; Wales</b>	EU Directive 2002/91/EC 